

QUICK REFERENCE GUIDE



# Akomolede

OPERATION MANUAL



← **On / Off Power Switch.**  
Please remember to turn off the switch when The device is not in use to conserve the battery life.

Thank you for purchasing our product!  
You will enjoy the fun brought to you and your children by learning Yoruba language with our products.

Please do read this guide thoroughly for better use of this product.  
Anyone or any party is not allowed to copy all or any parts of our products. Copycats will be prosecuted.

Since it is apparent that the Yoruba language is increasingly being relegated to the background, especially among the Yoruba elite.

There is need to develop Yoruba language so that it can also stand the test of time. In a few years, the world as you know it will change drastically by western cultures and ideas, and studies shows that the Yoruba elite is the first runner up in the list of self inflicted culture sabotage victims.

This is where V-Microsystems **Technologies** comes in the picture. We have invented some useful devices that we believe will help our children re connected to their culture again. This is one of our products "AKOMOLEDE".

# NO SERVICEABLE PARTS INSIDE

## BACK SIDE OF THE DEVICE

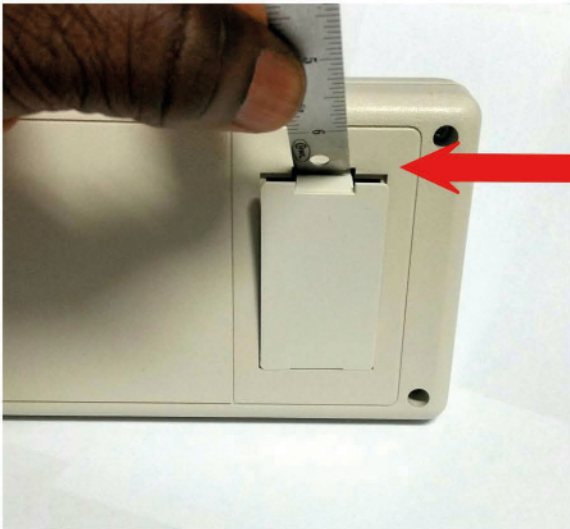

Gently pry the battery compartment lid open with a flat tool to access the battery for replacement.

### HINTS:

- To ensure that the product can be used normally, the battery should be connected when the power switch is turned off.
- Please turn off the product if not in use for long time.
- Excessive force or aggressive handling of the battery change can break the battery wire.
- Water must not come in contact with our device. Like any electronics device water will damage electronics parts and components.
- Do not drop the device on a hard surface from a height of more than six inches.
- Any sign of abuse on the device will cancel your 3 months warranty.

### TERMS ON 3 MONTHS WARRANTY:

We are not responsible for any damage from nature or act of God. Physical damage, reckless and careless use and abuse to the product will not qualify for the 3 months warranty. Please avoid use in the rain as damage will not be covered. Failure or damage caused by attempt to repair the device yourself is not acceptable for warranty.



The device uses 9 volt battery.

## COMMON PROBLEMS AND TROUBLESHOOTING WITH RECOMMENDED USE

1. If the message from the speaker is no longer coherent, muffled or sound rather abnormal.
  - Please change the battery.
  - There is no serviceable part inside. The components are semiconductors are guaranteed to work for 110 years. Your device can only damage through physical abuse and short-circuit through water, rain and fire contact.

For any questions, please contact us through our website and email [yorubalingua@gmail.com](mailto:yorubalingua@gmail.com)

THANK YOU FOR BUYING THIS DEVICE

*We Come In Peace!*